



ESBE AB
Bruksgatan 22
SE-333 75 Reftele
www.esbe.eu



ESBE System Units
CIRCULATION UNIT DN25, DN32



Mtrl.n: 98141121 Ritn.n: 7951 vers. A • Rev. 2022-12-01



Series GDA200
Series GRA200
Series GFA200

Series GBA200
Series GRC200



LVD 2014/35/EU
EMC 2014/30/EU
RoHS 2011/65/EU
ErP 2009/125/EU



SI 2016 No. 1101
SI 2016 No. 1091
SI 2012 No. 3032
SI 2010 No. 2617

PED 2014/68/EU, article 4.3
EnEV 2014

SI 2016 No. 1105

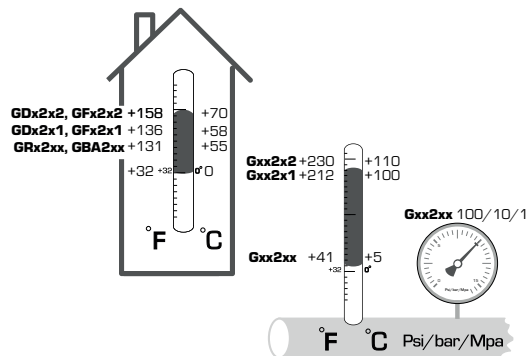

SERIES	FUNCTION
ESBE GDA211 GDA 212	
ESBE GFA211 GFA212	
GRA211 GRA212 GRA231 GRA232	
GRC221 GRC222 GRC241 GRC242	
ESBE GBA211	



Dimensions • Cabling

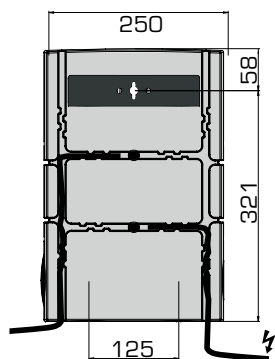

Mounting position

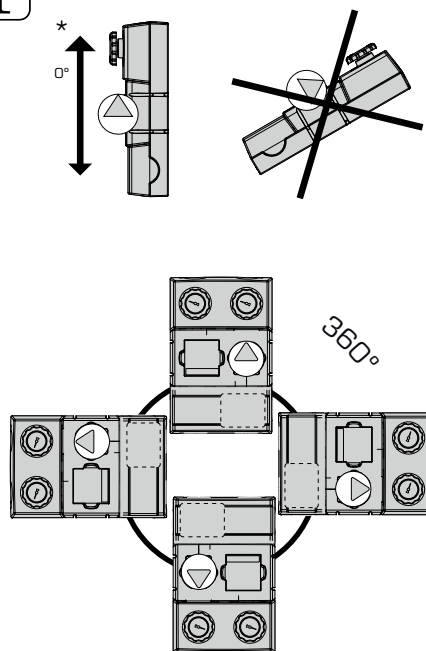

Remove actuator/controller

Series GRA2xx, GBA211, GRC2xx

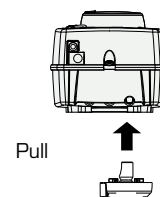
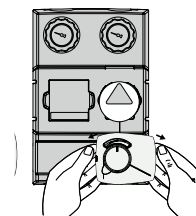

Remove insulation

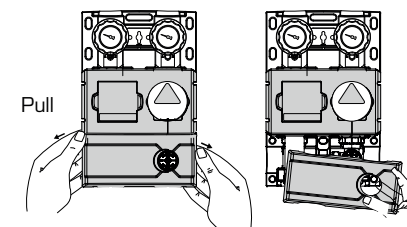
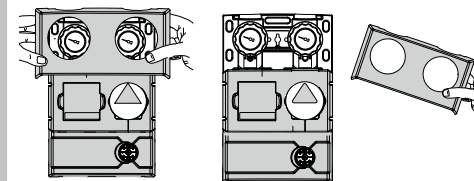

3

Assembling on wall

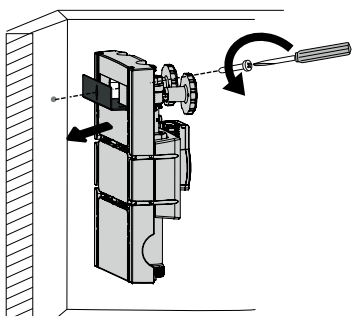

Adjust wallbracket

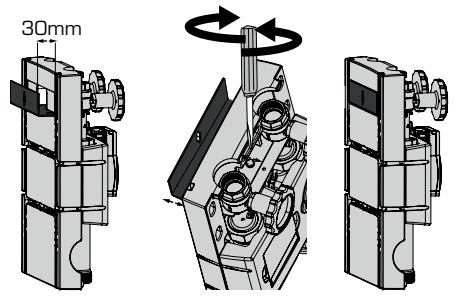

i

Commissioning actuator

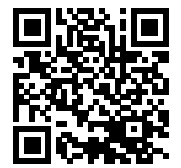
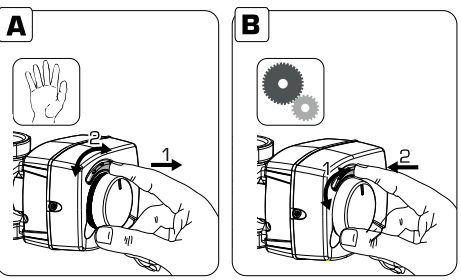

<https://esbe.eu/group/products/rotary-actuators>

4

Fit supply pipes

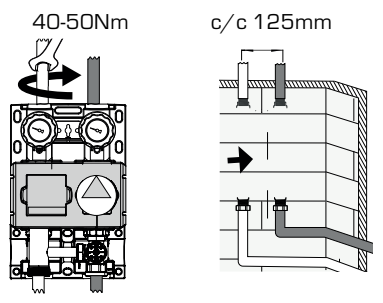

Assemble insulation

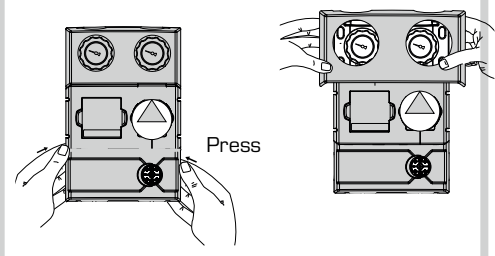

i

Commissioning fixed temperature

Series GFA211, GFA212

0,5	1	2	3	4	5	6
22°C	25°C	33°C	40°C	47°C	54°C	60°C

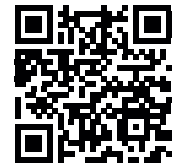

<https://esbe.eu/group/products/thermostatic-mixing-valves>

5

Assemble actuator/controller

Series GRA2xx, GBA211, GRC2xx

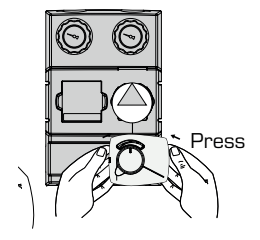

QUICK FIT!

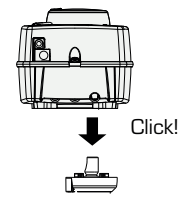

i

Electric installation

N (bn)
 N (bu)
 PE (gn)

CCW (bk)
 CW (bn)

www.esbe.eu

i

Commissioning

Preparation



Filling and venting

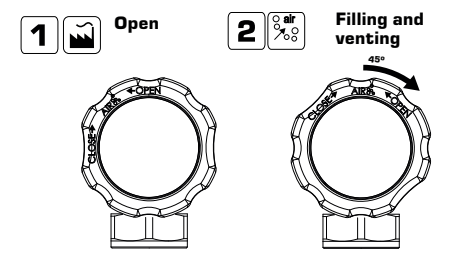

Assemble removed knob

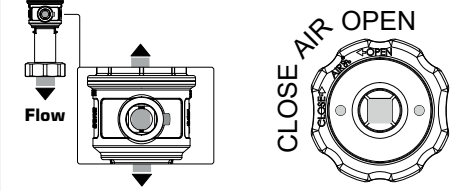

Checkvalve position

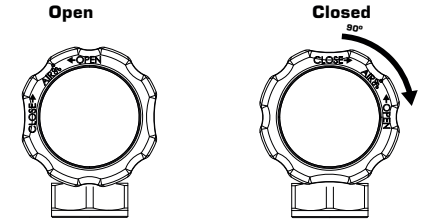

White mark, indicate check valve position

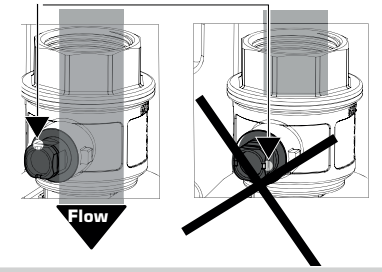

Wilo Display

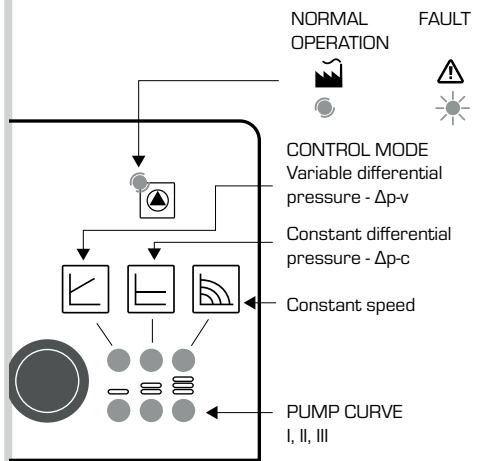

Pump Settings

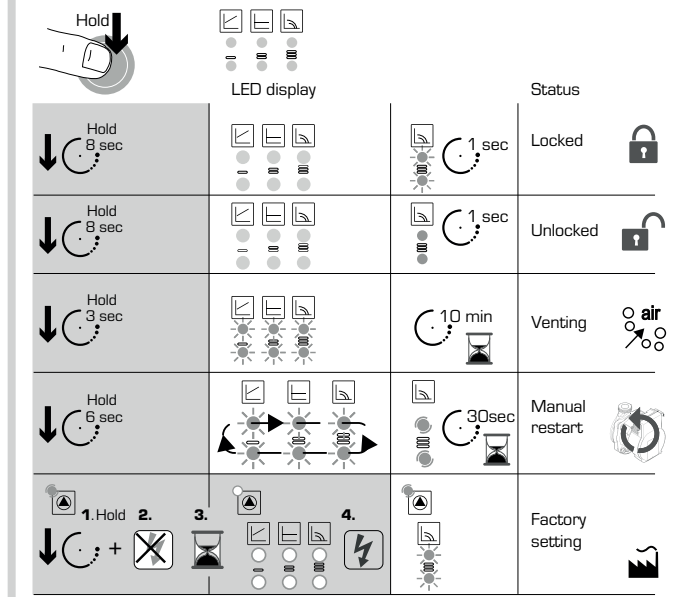

Settings navigations

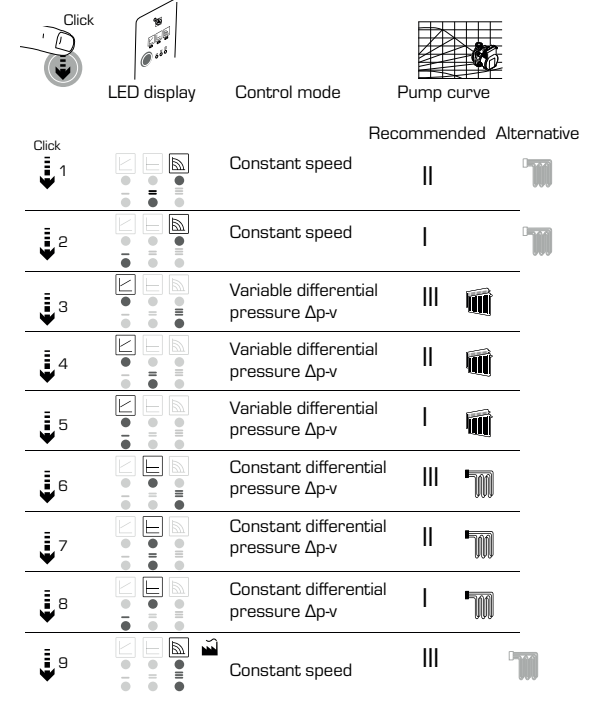

WILO - Faults, Causes and Remedies

LED Indicator	Meaning	Diagnostic	Cause	Remedy
lights green 	Pump in operation	Pump runs according its setting	Normal operation	
blinks red/green 	Pump in function but stopped	Pump restarts by itself after the fault is disappeared	1. Undervoltage $U < 160 V$ or Overvoltage $U > 253 V$ 2. Modul overheating: temperatur inside motor too high	1. Check voltage supply $195 V < U < 253 V$ 2. Check water and ambient temperature
blinks red 	Pump out of function	Pump stopped (blocked)	Pump does not restart by itself due to a permanent failure	Change pump
blinks orange 	Pump out of function	Pump stopped	Pump is not starting	Change pump
LED off 	No power supply	No voltage on electronics	1. Pump is not connected to power supply 2. LED is damaged 3. Electronics are damaged	1. Check cable connection to power supply 2. Check if pump is running 3. Change pump

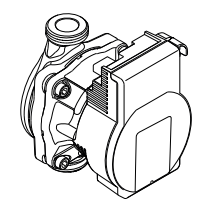

<http://www.esbe.eu/global/en/products/circulation units>

Factory setting

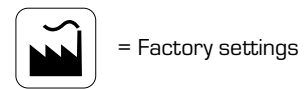



Grundfos Display

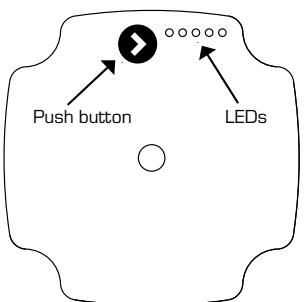

<http://www.esbe.eu/global/en/products/circulation units>



Grundfos - Faults, Display and Solutions

FAULT	DISPLAY	SOLUTION
OFF 0 V	[Display with arrow]	1. Check power supply 2. Check system controller
ON 230 V	RED YELLOW	1. 1/On 2. 0/Off 3. Adjust screw (5 mm No.2)
ON <160 V	RED YELLOW	1. Check wiring (L, PE, N)
ON 230 V	RED YELLOW	1. 1/On 2. 0/Off 3. Check pump assembly



Settings navigation

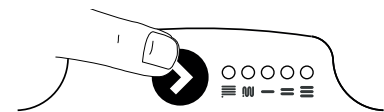

MODE	UPM3 xx-50	UPM3 xx-70	Display
[Fan icon]	1	1	[Display]
[Fan icon]	2	2	[Display]
[Factory icon]	3	3	[Display]
MODE	UPM3 xx-50	UPM3 xx-70	Display
[Fan icon]	1	1	[Display]
[Fan icon]	2	2	[Display]
[Fan icon]	3	3	[Display]
MODE	UPM3 xx-50	UPM3 xx-70	Display
[Fan icon]	1	1	[Display]
[Fan icon]	2	2	[Display]
[Fan icon]	3	3	[Display]
[Fan icon]	AUTO _{ADAPT}	AUTO _{ADAPT}	[Display]
[Fan icon]	AUTO _{ADAPT}	AUTO _{ADAPT}	[Display]



Expose application info using leaflet

